

# ST 18/6poles Female parts

coding

brown/black

black/black

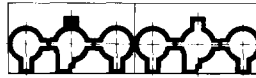

double screw connection  
strain relief for two round cables  
diameter 8.5–10.5 mm

one cable inlet open  
one cable inlet to be cut out

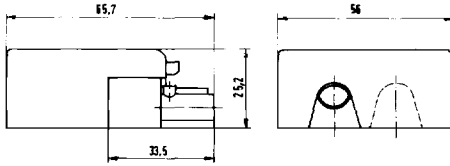

single screw connection  
strain relief for two round cables  
diameter 8.5–10.5 mm

one cable inlet open  
one cable inlet to be cut out

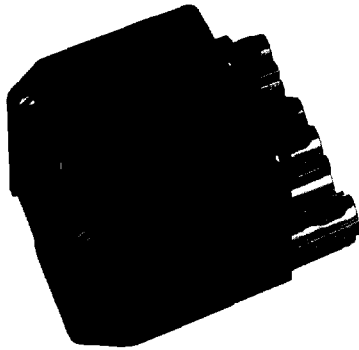
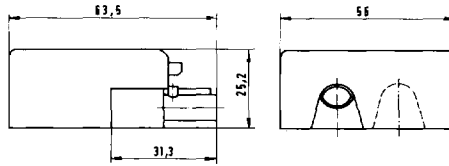

**female part** assembled  
with strain relief with locking device  
black/brown **93.733.3953.0** 100  
black/black<sup>2</sup> **93.733.4153.0** 100

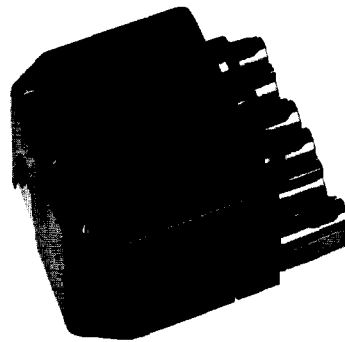

**female part** assembled  
with strain relief with locking device  
black/brown **93.733.7553.0** 100

**female part** unassembled  
with strain relief with locking device  
black/brown **93.933.3953.0** 100  
black/black<sup>2</sup> **93.933.4153.0** 200

**female part** unassembled  
with strain relief with locking device  
black/brown **93.933.7553.0** 100

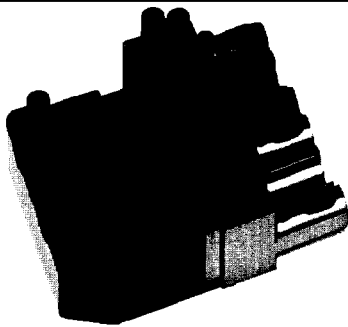

**female part** with strain relief bottom part  
black/brown **93.033.7653.0** 100

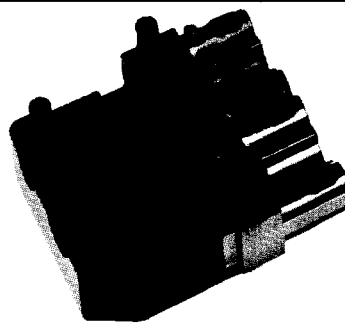

**female part** with strain relief bottom part  
black/brown **93.033.7553.0** 100

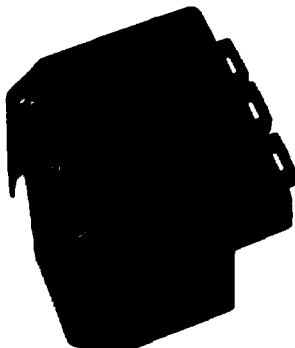

**strain relief upper part**  
black **27.419.3353** 100

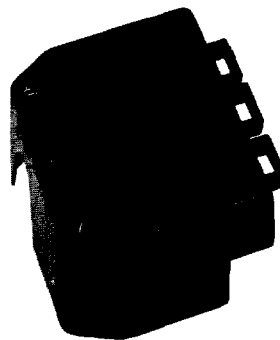

**strain relief upper part**  
black **27.419.3153** 100